

AV2 Keep Routing Details for Timber and Composite Door Sashes with Ecoframe

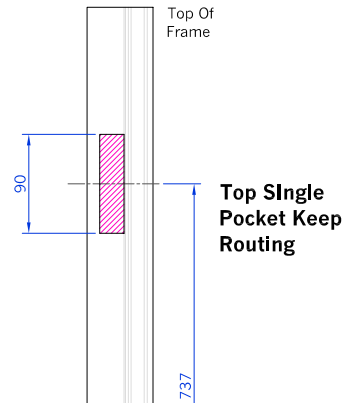

F24 Rounded End Single Pocket Keep

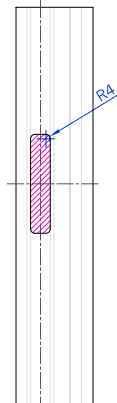
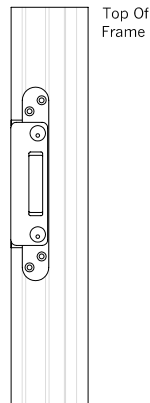

F24 Rounded End Centre Keep

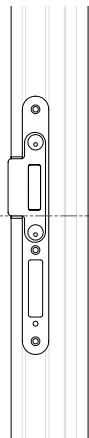

Line In STV Faceplate Denotes Lock Spindle Centre.

Spindle Centre

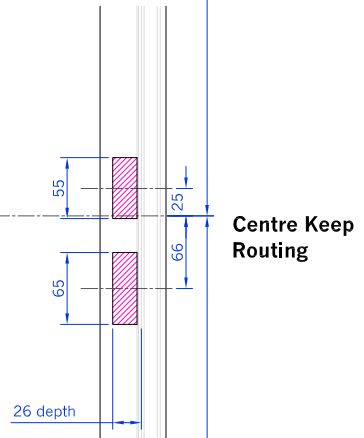
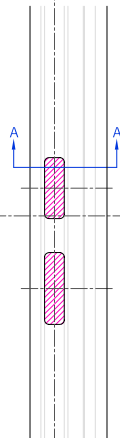
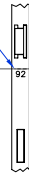

F24 Rounded End Single Pocket Keep

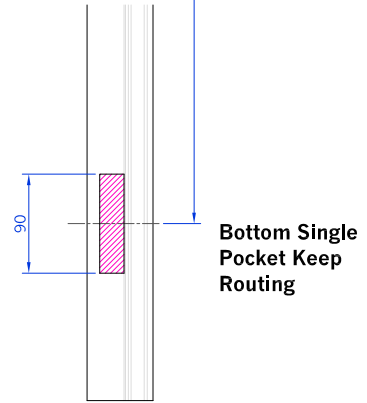
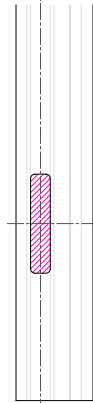
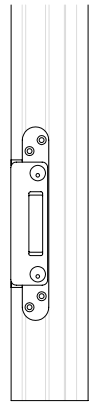

PLAN VIEW

PLAN VIEW

SIDE VIEW

Denotes Routing

NOTE
Ensure That All Routing Material Is Cleared From Stile Before Fixing Lock.

Routing Details Based On Working Air Gap Of 4mm

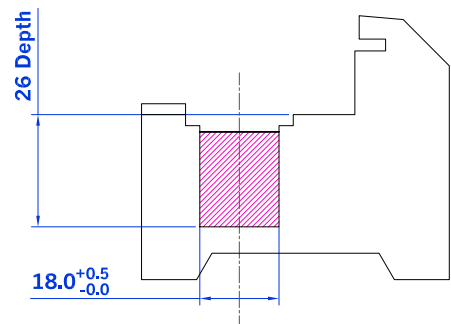

SECTION A-A

| | |
|------------------------------|--|
| Drawn C Harris | This drawing is the property of Winkhaus (UK) Ltd and is not to be reproduced or copied in any form without written consent. |
| Scale N/A | |
| Drawing No. D08016 | Issue A |
| | Date 05/10/08 |