

Technical Documentation

TAP Wiring Box 230 V



TAP wiring box 230 V

Wiring box for a safe and expert connection of blueChip und blueSmart upload readers.

Suitable for BCTA, BCTA ZE, BCTA ZI, BSTA, BSTA ZE and BSTA ZI.

Enables wiring of up to three upload readers with a COM server.

For the power supply of the upload readers and the COM server an integrated power supply unit is used. The COM server is not included in the scope of delivery.

Technical data

Box

- Colour: traffic white (RAL 9016)
- Dimensions (H x W x D): 500 mm x 300 mm x 225 mm
- Weight: 8.91 kg
- Protection class 1
- IP 43 according to DIN EN 60529
- Box made of steel sheet
- Single-sash door made of steel sheet

Operation site

- Used indoors (e. g. in engineering or server rooms)



TAP wiring box 230 V

Installation and connection instructions

- Vertical installation on a wall
- Supply and discharge lines from top
- Network connection via lateral RJ45 socket
- Wiring of upload readers with terminal block

Scope of delivery

- Wiring box with integrated power supply unit and service socket
- Fixing material (screws and dowels)
- COM server not included in the scope of supply

Item number: 506 925 7

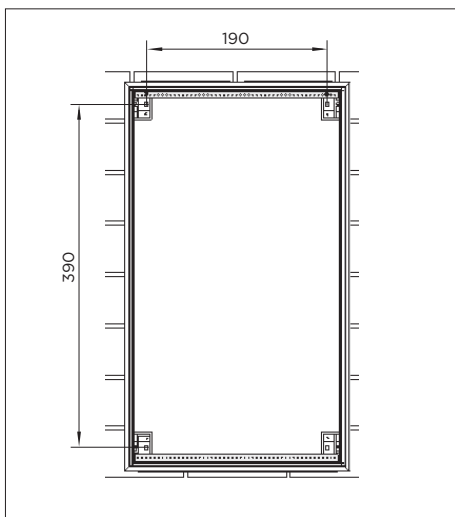

TAP wiring box: drilling template

Wiring diagram

